

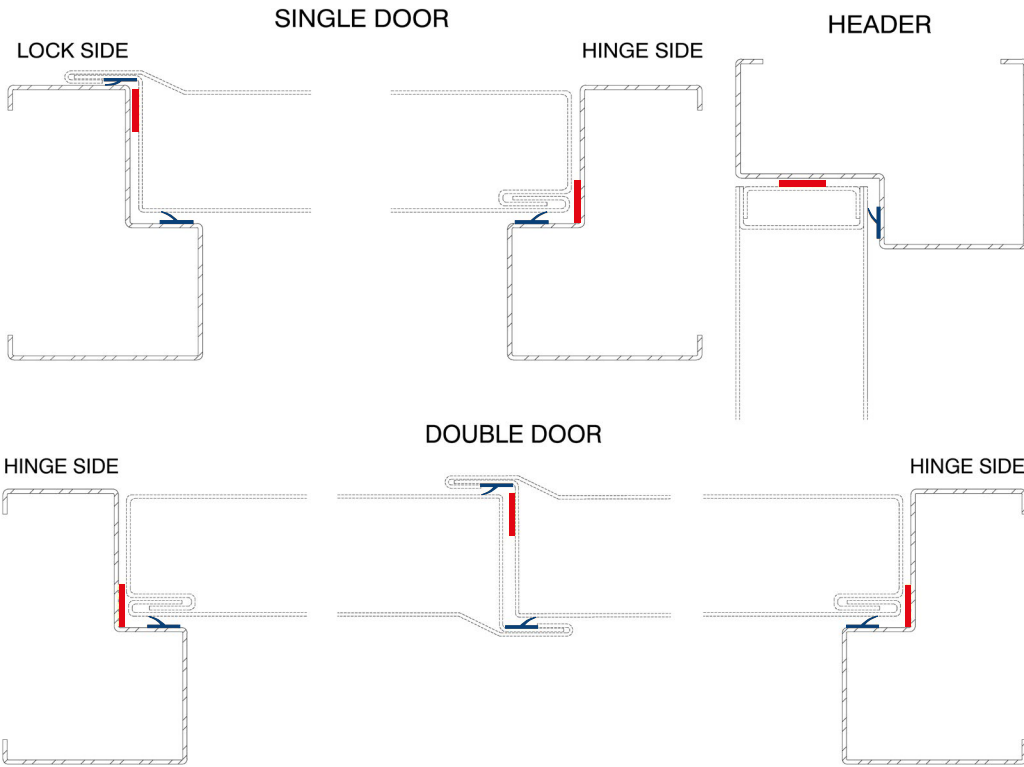

# STRONGDOR SEALS

## INSTALLATION INSTRUCTIONS

### TEE FIN SEAL



**SMOKE OR WEATHER RATED DOORS**

The expander jamb should be sealed with silicone (approved fire silicone if the door is fire rated).

If needed, Tee Fin seal and intumescent seal can be fitted on top of each other.

Tee Fin Seal

Examples of where the intumescent seal can be installed.

### P SEAL

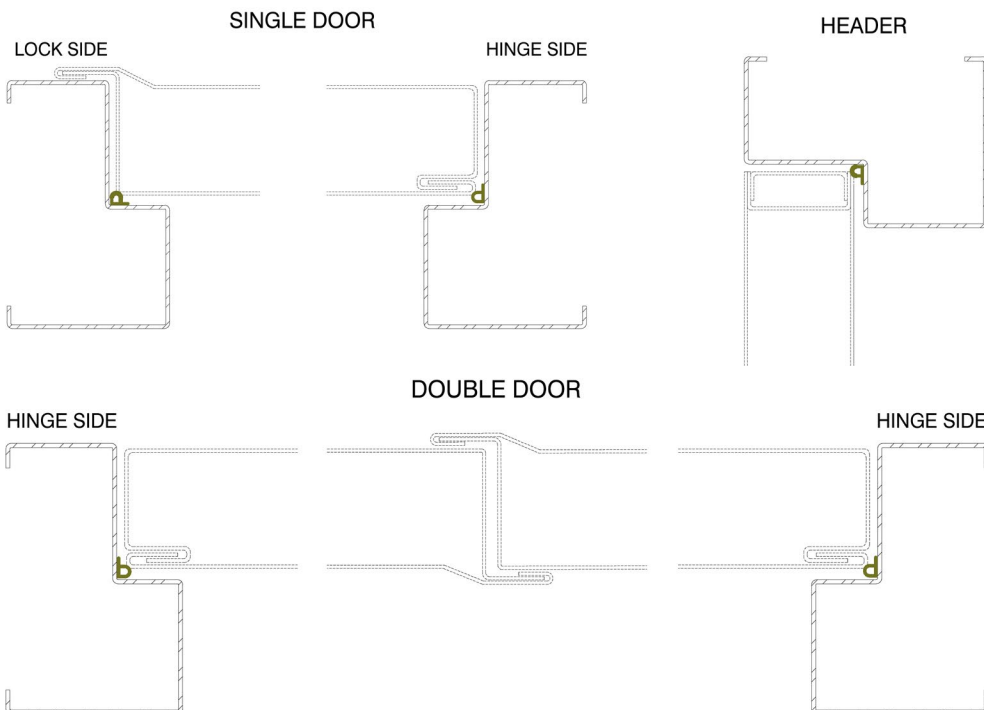

P Seal

# INTUMESCENT SEAL

## SINGLE DOOR

HINGE SIDE (Option 1)

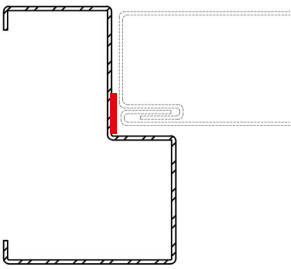

HINGE SIDE (Option 2)

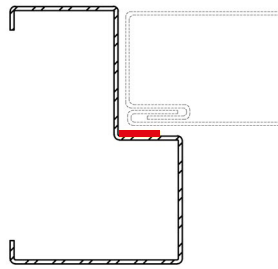

LOCK SIDE (Option 1)

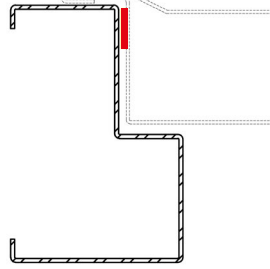

LOCK SIDE (Option 2)

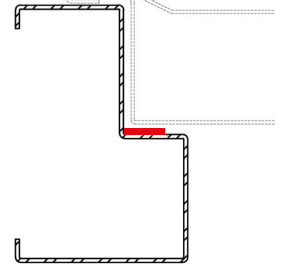

DOUBLE DOOR (Option 1)

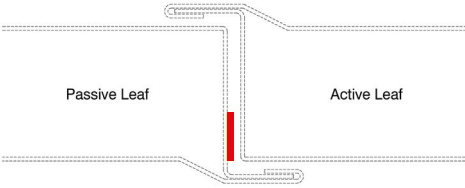

TOP OF THE LEAF

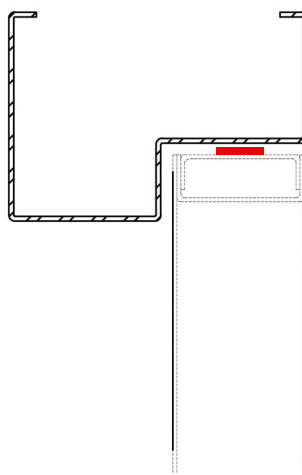

1.8MM Thick intumescent seal

DOUBLE DOOR (Option 2)

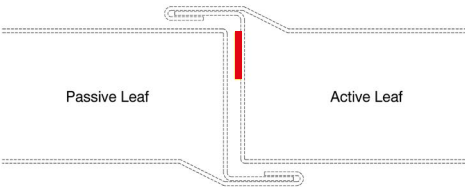

# TEAR DROP SEAL

## SINGLE DOOR

LOCK SIDE

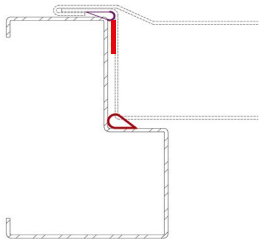

HINGE SIDE

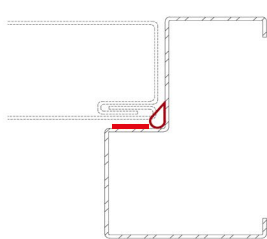

## HEADER

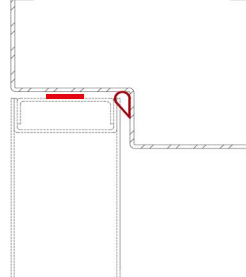

## DOUBLE DOOR

HINGE SIDE

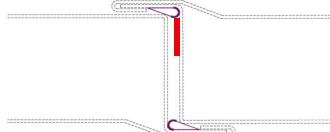
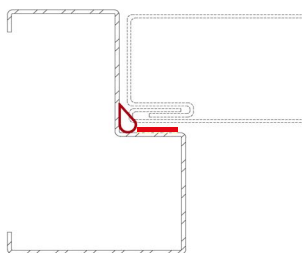

HINGE SIDE

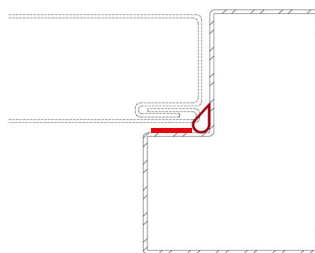

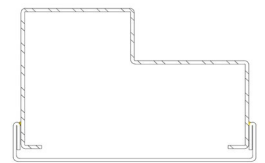

## ACOUSTIC OR WEATHER RATED DOORS



On acoustic or weather rated doors the Expander Jamb should be sealed with silicone (approved fire silicone if the door is fire rated).

 Small tear drop seal to be installed on astragal.

 Big tear drop seal to be installed on from perimeter.

 Examples of where the intumescent seal can be installed.